

abbotFox



Filby, NR29

The detail

abbotFox presents this stunning six bedroom detached family home neatly arranged over three floor overlooking fields to the rear.

Generously proportioned throughout, accommodation briefly comprises; an inviting entrance hall, a most impressive kitchen living dining room with bi folding doors out onto the garden. In addition to this is there is a snug, WC and useful utility room.

The first floor provides four bedrooms, the principal bedroom with an en suite shower, there is a family bathroom off the landing also.

A second floor features two two bedrooms and a shower room off the landing,

Outside, to the rear, there is a professionally landscaped and enclosed garden with a natural stone patio and paths. Provision is in place for a hot tub.

To the front, there is a substantial driveway and detached double garage.

Guide price £625,000 - £675,000

Let's talk

01603 660000

sales@abbotfox.co.uk

@abbotfox



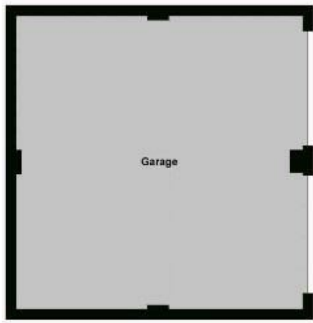

Garage



Second Floor
Approximate Floor Area
553 sq. ft
(51.38 sq. m)



Ground Floor
Approximate Floor Area
1091 sq. ft
(101.44 sq. m)



First Floor
Approximate Floor Area
1093 sq. ft
(101.56 sq. m)

Approx. Gross Internal Floor Area 2737 sq. ft / 254.38 sq. m

Produced by Elements Property



Perfectly placing people with property

Location



EPC

Energy Efficiency Rating		
	Current	Potential
<i>Very energy efficient - lower running costs</i>		
(92 plus) A		
(81-91) B		
(69-80) C		
(55-68) D		
(39-54) E		
(21-38) F		
(1-20) G		
<i>Not energy efficient - higher running costs</i>		
England & Wales		EU Directive 2002/91/EC 

Disclaimer – In accordance with the Property Misdescriptions Act, the company gives notice that all descriptions, references to condition, necessary permissions for use and other details are given in good faith and believed to be correct, but any intending lessees do not rely on them as statements of fact, but must satisfy themselves by inspection or other means, as to their accuracy.

**—
WE
WON!**



**BRITISH
PROPERTY
AWARDS**

2024



GOLD WINNER

**ESTATE AGENT
IN NORWICH
(NR3-9)**



SELLING?
THINK **abbotFox**